

Wood Pole Bracket

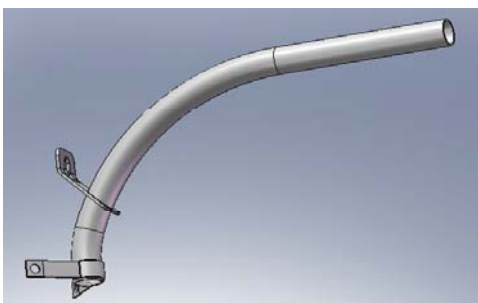

Application: For use with select HI utility grade luminaires.

Features:

- Complies with ANSI C136.13-2004 Metal Brackets for Wood Poles.
- Suitable for use with UNH or USC series fixtures.
- Includes mounting hardware: (2) 1/2-6 x 3" Lag Screws, (1) 5/8-11 x 11" Bolt, 5/8 washer, 5/8 lock washer, & 5/8 hex nut.
- Approximate weight - 2 lbs.

Catalog #	Description
MA-WPB-150A-024	Aluminum 24-inch mounting arm, 1-1/2" diameter.
MA-WPB-150A-030	Aluminum 30-inch mounting arm, 1-1/2" diameter.

Specifications subject to change without notice.

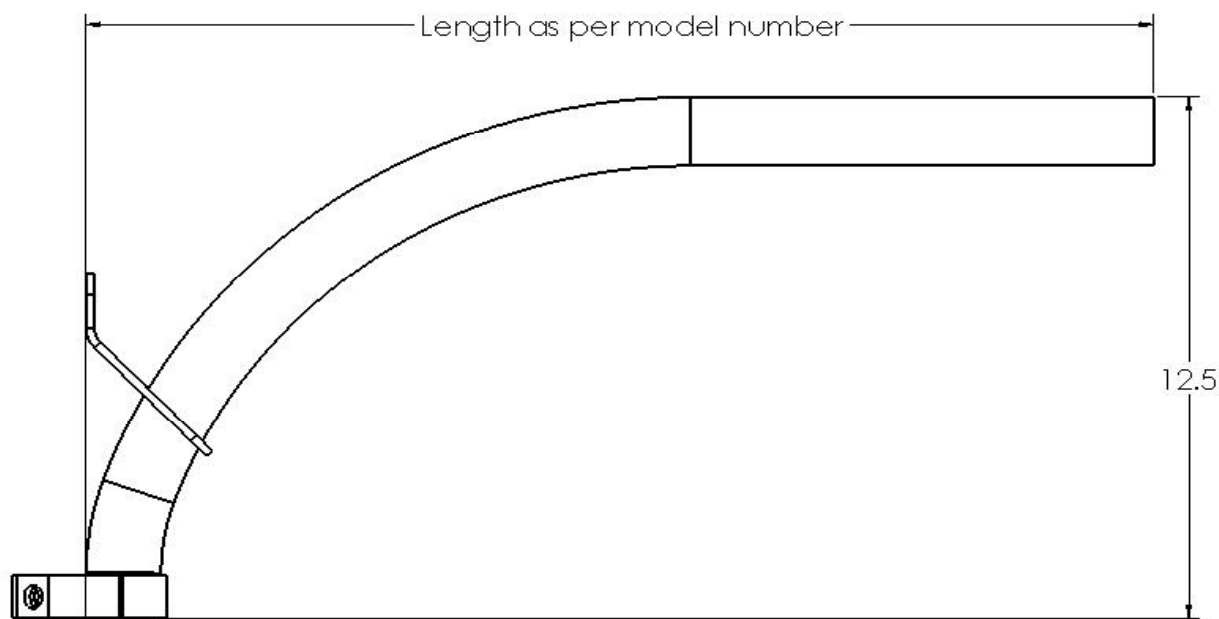

Dimensions shown in inches.