

Wall Pack Mounting Plate

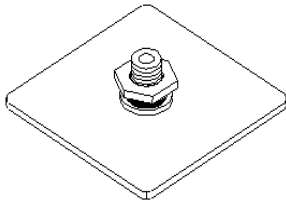

WPMP being displayed.

Application: For use with select WP series Fixtures for mounting purposes.

Features: Includes mounting plate and mounting hardware.
 Approx. Body Dimensions: 4" square x 0.8" tall threaded tube.
 Approx. Weight = 0.2 lbs.

Catalog #	Description
WPMP	Die-cast wall pack mounting plate with locknut, O-ring, and weatherproof gasket.

Specifications subject to change without notice.

