

5/1/2017

Horizontal Flood

HPS / 150 - 400 watts | PS / 400 watts

Applications

Great for lighting building facades, displays, signs, or for general security lighting purposes

Features

- Die-cast housing with hinged top frame for easy relamping (lamp included)
- Tempered glass lens
- Textured bronze finish
- UL listed for wet locations
- EPA = 1.31 sq. ft.; Max. fixture weight = 29 lbs.

**RAPID SHIP MODEL
AVAILABLE FOR NEXT DAY SHIPMENT**

- HFL-400-PS-5T-A

Project:	
Catalog#:	
Approved by:	



ORDERING INFORMATION

Catalog #	Watts	Volts †	Ballast	ANSI	Lamp Part #	
HFL-150-HPS-4T-A	150 HPS	4T	HX-HPF	S55	LU150/55	*
HFL-250-HPS-4T-A	250 HPS	4T	CWA	S50	LU250	*
HFL-400-HPS-4T-A	400 HPS	4T	CWA	S51	LU400	*
HFL-400-PS-4T-A	400 PSMH	4T	PS-CWA	M155	MH400/BU/PS	*
HFL-400-PS-5T-A	400 PSMH	5T	PS-CWA	M155	MH400/BU/PS	* (E)

FACTORY INSTALLED OPTIONS

Catalog #	Description	Accessory Code*
HFLSY	Small-mounting yoke with stamped-steel construction	A

*When ordering, include the Accessory Code with the catalog number (e.g. HFL-150-HPS-4T-A)

ACCESSORIES (sold separately)

Catalog #	Description	
HFLWG	Wire guard with stainless steel construction	*
HFLGS	Glare shield that can be reverse mounted to use as a back cutoff	*
HFLVG	Vandal resistant, clear polycarbonate PC guard	*
HFLSY	Small-mounting yoke with stamped-steel construction	*
HFLLY	Large-mounting yoke with stamped-steel construction	*

* LIMITED QUANTITIES AVAILABLE

† 4T = 120, 208, 240, 277 volts (pre-wired to 277)
5T = 120, 208, 240, 277, 480 volts (pre-wired to 277)

Circle E logo indicates that this product complies with federal energy efficiency requirements.



Specifications subject to change without notice.

DIMENSIONS

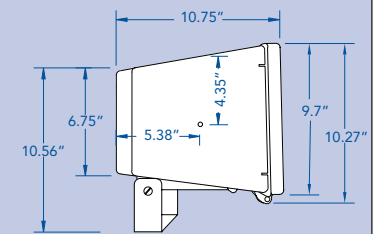
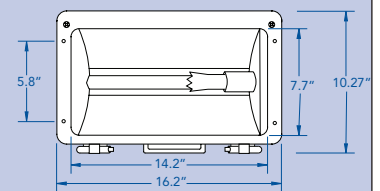

MOUNTING DETAIL

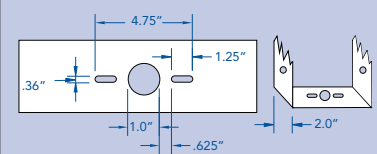

PHOTOMETRICS

400W MH @ 15' Mounting Height
and aimed 30° Below Horizontal
Isofootcandles

