

VSx Series Vaporproof Fluorescent Strip INSTALLATION INSTRUCTIONS

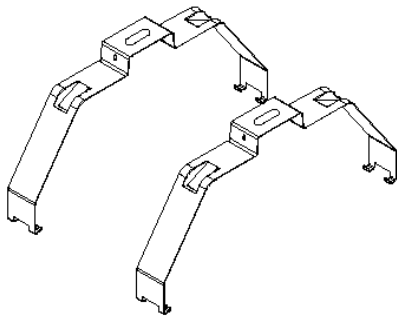

MOUNTING:

1. Securely attach mounting brackets (2) to mounting surface (brackets can be surface, chain, or cable mounted). The VSx enclosure will engage the mounting brackets at any point along the fixture's length, except where there are latches. It is recommended that the distance between brackets equal 70 - 80% of the fixture's length.



Mounting Brackets

2. Insert one side of the fixture into mounting brackets.

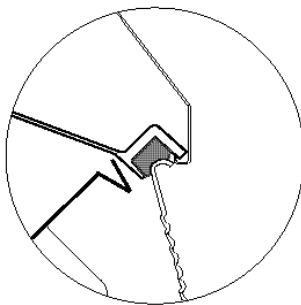
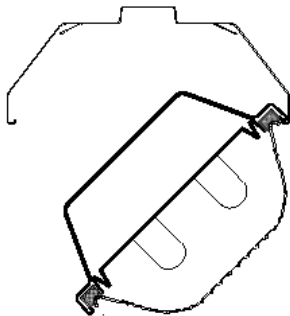

WARNING:

Disconnect power during installation and before servicing. Wear gloves to prevent cuts/abrasions from sharp edges when removing from carton, handling, and maintaining this fixture.

SAFETY:

This fixture must be wired in accordance with the National Electric Code and applicable local codes or ordinances. All work should be performed by a qualified electrician. To insure personal safety, proper grounding is required (connect green fixture lead to supply ground).

IMPORTANT:

Read all instructions carefully before attempting installation. If you do not understand these instructions, please consult your local distributor.

Thoroughly inspect the fixture for any freight damage; freight damage should be reported to the delivery carrier.

MOUNTING (cont):

3. Push up on fixture and press in on the mounting bracket until the mounting bracket snaps into place.

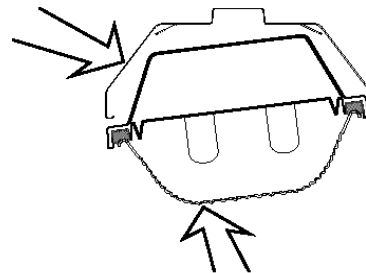

4. Verify that the enclosure is fully supported before connecting to a power supply.

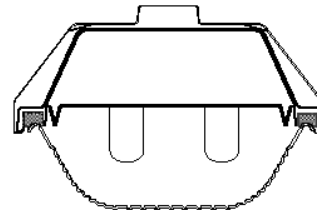

WIRING CONNECTIONS: (Use only approved connectors for all electrical connections.)

1. VSx Series Strips utilize a geartray that is supported by two/three retaining clips. To open wiring compartment, depress clips and push them through the geartray. There are hooks on the retaining clips from which the geartray can hang. Geartray should be "eased" down; DO NOT allow the geartray to 'drop free' and swing.
2. Connect the black fixture wire to the black supply wire (line).
3. Connect the white fixture wire to the white supply wire (neutral).
4. Connect the supply ground wire to the green fixture wire (or GRD screw if provided).
5. Ballast Voltage: This fixture is typically provided with a multi-volt ballast (120-to-277v), but may have a single tap ballast (such as 120v only). Ensure that the supply voltage is correct for the ballast in this fixture.

Instructions Continued on Reverse.

REASSEMBLY / LAMP INSTALLATION:

1. Reinstall the geartray; carefully placing it back into the retaining clips insuring that no wiring is pinched. Remove protective film from reflector (if provided).
2. Install fluorescent lamps. Insert each lamp into sockets and turn until the lamp 'snaps' into place. If lamp replacement is necessary, insure that the lamp is the same wattage and type as indicated on the ballast label.
3. Replace the lens ensuring that all latches are fully engaged.

ENSURING VAPOR-TIGHT SEAL:

1. Ensure that all latches are fully engaged.
2. Vapor-tight bonding between conduit and connections is not automatic and must be provided as a part of the installation. This should be achieved by appropriate application of gasket material or RTV Silicone (or equivalent).
3. Do not cut or drill holes into housing, lens, or gasket. If it is necessary, due to unique circumstances, to do so, the fixture should be well sealed with RTV Silicone (or equivalent).

TROUBLESHOOTING TIPS: If the fixture fails to operate properly, check the following:

- ✓ Verify the correct lamp type is used and properly installed.
- ✓ Verify the lamp is not defective (try known good lamp).
- ✓ Verify proper line voltage is present.
- ✓ Verify fixture wiring (refer to schematic printed on ballast label).
- ✓ Verify that the fixture geartray is grounded.

⚠ WARNING: Improper seating of lamps can create a fire hazard. Whether field or factory installed, ensure lamp position is correct before energizing fixture. See Diagrams 1 and 2.



Diagram 1-T8 lamp seating

The dimple on the lamp base is aligned with the slot in the lamp holder.



Diagram 2-T5 lamp seating

The flat surface of the lamp base is perpendicular to the slot in the lamp holder



WARNING: These procedures should only be performed by a qualified electrician. Supply power should be turned off when replacing components or checking connections. Never perform maintenance or cleaning while fixture is energized. Disconnect power and allow lamp to cool before replacing.