

LED Flat Panel

**PLEASE READ INSTRUCTION BEFORE COMMENCING INSTALLATION AND RETAIN FOR FUTURE REFERENCES.**

**Electrical products can cause death or injury, or damage to property. If in any doubt about the installation or use of this product, consult a competent electrician.**

**Applies to**

LFP22XXAMV & LFP24XXAMV Series

**Table 1: Product Specifications**

Model	Watt	Input Voltage	LED Drive Current	Viewing Angle	Ra	PF	Dimming
LFP22XXAMV	40	100-277VAC	1000mA	120°	>80	>0.9	0-10V
LFP24XXAMV	50		1050mA				

Where XX represents CCT (30=3000K, 35= 3500K, 40=4000K, 50=5000K)

Note: Above table shows typical configurations. Additional options are possible based on customer needs, including – Emergency panel lights. Emergency power can be 4-20W for 90 minutes.

**Recessed Installation**

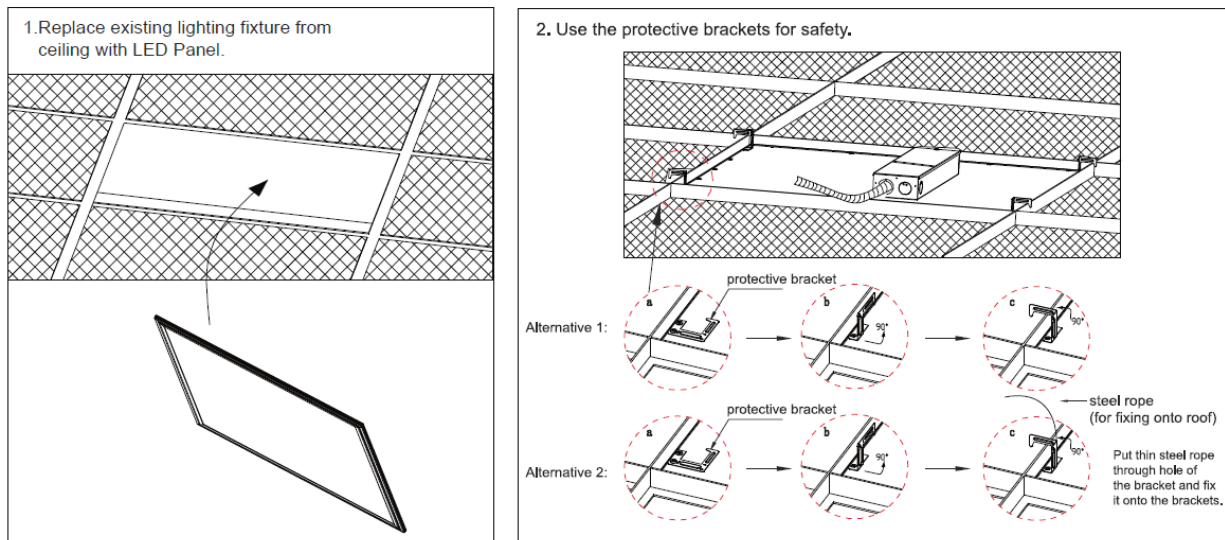

**Installation Guide**

